

PRECISION ORIFICE FITTINGS



Filtration	5 micron filter (<i>recommended</i>)
Materials, Wetted	Stainless steel, FKM, and ruby or sapphire
Media	Air, liquid, and compatible gases
Mounting	Cartridge or in-line
Orifice	0.001" to 0.010" (0.03 to 0.25 mm)
Pressure, Max.	500 psig
Temperature Range	-20 to 400°F (-29 to 204°C)
Thread	#10-32 or M5
Tolerance	± 0.0001 " (0.0025 mm)
More Details	clippard.com/link/pof

With tolerances of ± 0.0001 " (0.0025 mm), Clippard's precision orifice fittings are engineered for applications where minute flow adjustments are critical. Whether optimizing fuel injection in aerospace applications or fine-tuning fluid dynamics in industrial processes, or ensuring precise dosages in medical, analytical, and life science applications, these meticulously manufactured orifice fittings enable you to achieve the ultra-precise flow control your systems demand.

- Exceptional precision for unparalleled accuracy
- Tolerances of ± 0.0001 " (0.0025 mm)
- Seamlessly integrates into existing systems
- Orifice calibration available

Applications

- Precision flow control of gases or liquids
- Fuel injection systems
- Dynamic industrial fluid processes
- Pneumatic or hydraulic circuits requiring accurate timing
- Precision dosing for medical, analytical, and life science
- Ultra high pressure waterjet
- Liquid and gas control units
- Flow meters
- Inkjet printing

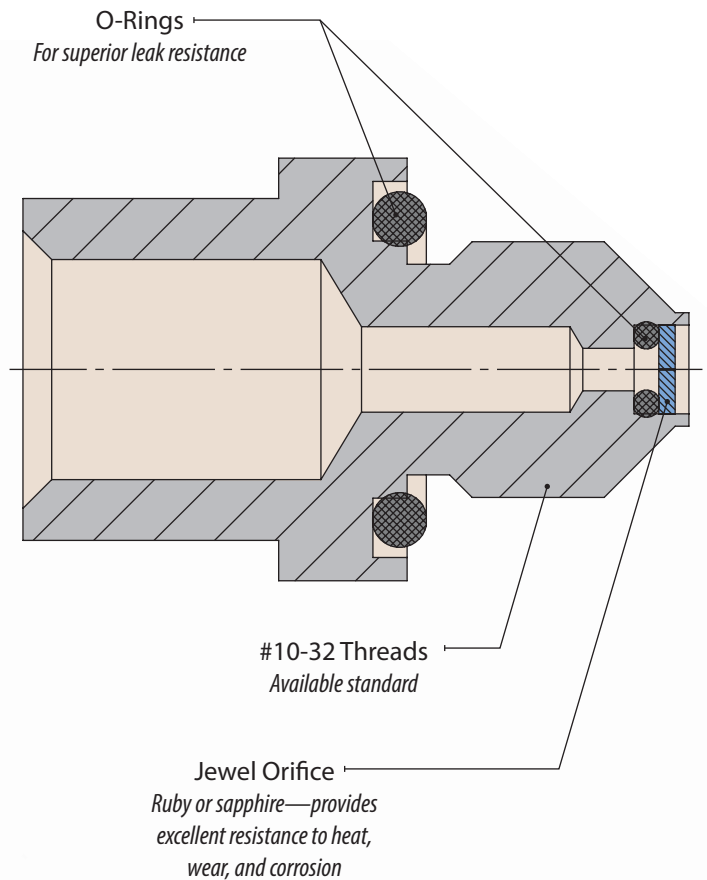

TYPICAL FLOW

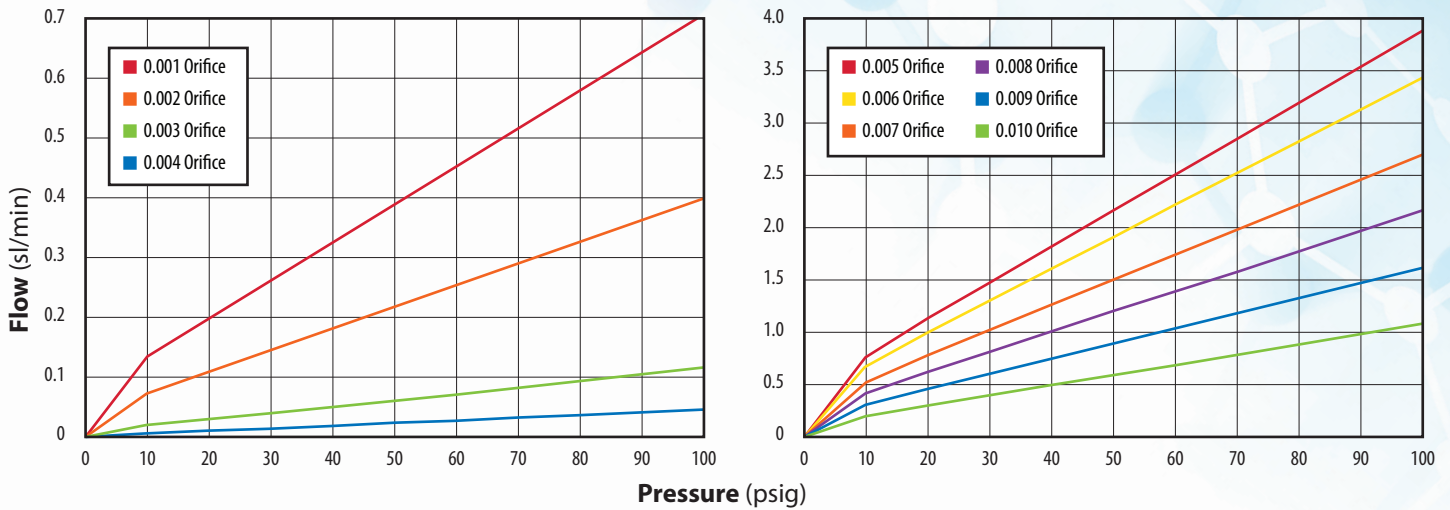

Cartridge

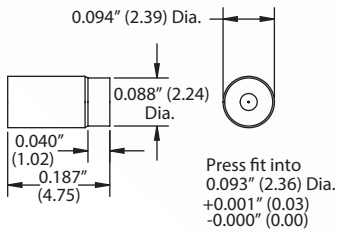

Dimensions shown are in inches (millimeters listed in parentheses).

Visit clippard.com for more detailed 2D and 3D drawings.

Male

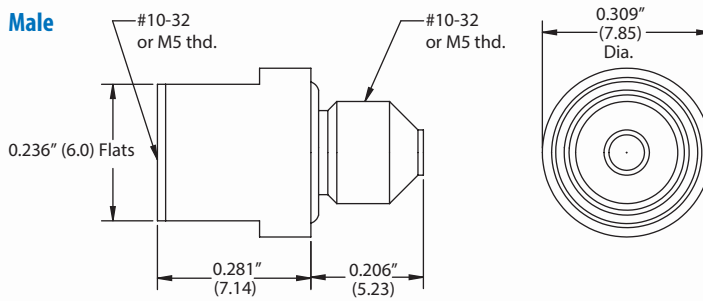

Female

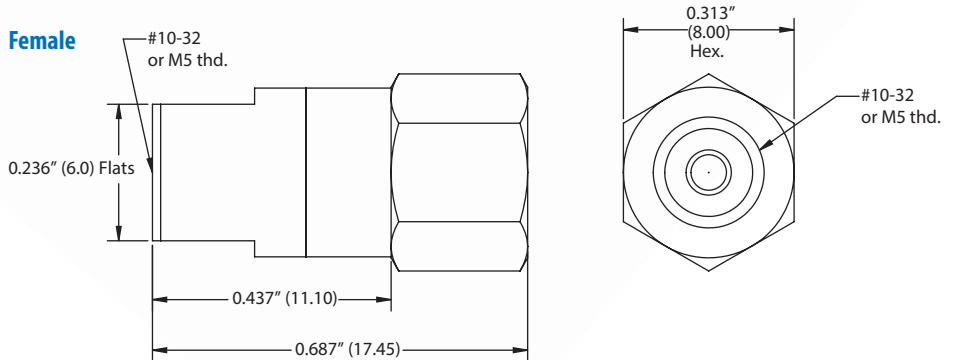

ORDERING INFORMATION

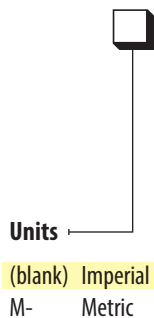

Orifice

001	0.001" (0.03 mm) orifice	006	0.006" (0.15 mm) orifice
002	0.002" (0.05 mm) orifice	007	0.007" (0.18 mm) orifice
003	0.003" (0.08 mm) orifice	008	0.008" (0.20 mm) orifice
004	0.004" (0.10 mm) orifice	009	0.009" (0.23 mm) orifice
005	0.005" (0.13 mm) orifice	010	0.010" (0.25 mm) orifice

Mounting

F	Female
M	Male
C	Cartridge

Example Part Number:

FO-001-F

Contact Clippard for custom flow calibrations or to discuss other orifices, from 0.011" to 0.050" (0.28 to 1.27 mm).

For more info, scan the QR code or visit clippard.com/link/pof

