



#10-32 RUN TEES

All fittings are ENP (Electroless Nickel-Plated)

#10-32 Male to Barb

(5/pack)

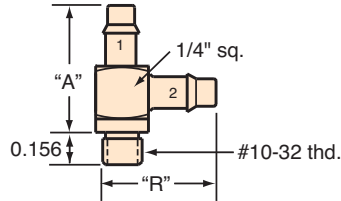

Barb 1 (ID)	Barb 2 (ID)	Order No.	"A"	"R"
1/16"	1/16"	TT2-2	0.515"	0.460"
1/16"	1/8"	TT2-4	0.500"	0.525"
3/32"	3/32"	TT3-3	0.543"	0.493"
1/8"	1/16"	TT4-2	0.593"	0.460"
1/8"	1/8"	TT4-4	0.593"	0.538"

Nitrile gasket included, not installed

#10-32 Male to Barb Swivel

(5/pack)

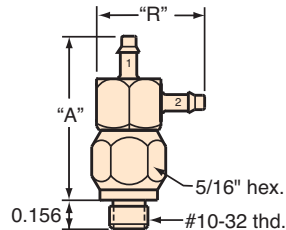

Barb 1 (ID)	Barb 2 (ID)	Order No.	"A"	"R"
1/16"	1/16"	ST2-2	0.781"	0.516"
3/32"	3/32"	ST3-3	0.821"	0.556"
1/8"	1/8"	ST4-4	0.872"	0.556"

Gasket included, not installed



Universal #10-32 to Barb

(5/pack)

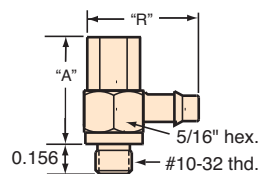

Barb (ID)	Order No.	"A"	"R"
1/16"	UTF-2	0.562"	0.504"
3/32"	UTF-3	0.562"	0.556"
1/8"	UTF-4	0.562"	0.576"

Nitrile o-ring included

Universal #10-32

(5/pack)

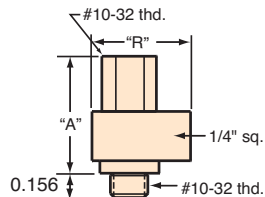

Order No.	"A"	"R"
UTF-F	0.562"	0.500"

1/8" NPT Male to Barb

(5/pack)

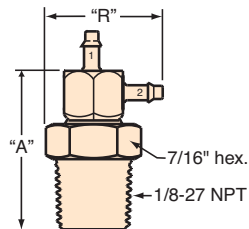

Barbs (ID)	Order No.	"A"	"R"
1/16"	SP2-2	1.031"	0.625"
3/32"	SP3-3	0.656"	1.062"
1/8"	SP4-4	1.156"	0.718"

Barb to Barb Swivel

(5/pack)

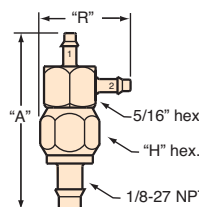

Barb 1 (ID)	Barb 2 (ID)	Order No.	"A"	"R"
1/16"	1/16"	S42-2	1.074"	0.531"
1/8"	1/8"	S44-4	1.183"	0.611"